



RV PRODUCT DATA SHEET
OEM: 4008-101-A65
AFTERMARKET: 4008-101-E65

The Next Generation SHURflo RV pumps guarantee quiet operation and smooth performance while providing the ultimate in durability and reliability. Designed and built specially for the RV industry the Next Generation SHURflo pumps are equipped with internal adjustable pressure switch and by-pass.

TYPICAL APPLICATIONS

Multi-fixture RV adjustable by-pass fresh water pump installation. Other uses may included 12V DC pressurized water systems in cabins. This pump may be used for general water transfer. For other applications contact SHURflo.

PUMP

Type: 4 Chamber Diaphragm with adjustable pressure switch and by-pass
 Ports: 1/2"-14 NPSM-Male.
 Liquid: 130 °F [54 °C] Max
 Prime: 6 feet [1.82 M]
 Inlet PSI: 30 PSI [2.1 Bar] Max
 Run Dry: Yes

ELECTRICAL

Motor: 12VDC Permanent Magnet, Intermittent Duty
 Protection: Thermal Overload, Automatic Restart
 Leads: 16 AWG, 16" [40 cm] Red +, 10" [33 cm] Black -
 Fuse: 10 Amp Recommended
 Control: Adjustable Switch with Check Valve.
 Shut-Off 55 PSI [3.8 Bar] ± 5 PSI [0.4 Bar]
 Restart 25 PSI [1.7 Bar] ± 5 PSI [0.4 Bar]

MATERIALS

Housing: Polypro
 Valves: EPDM
 Diaphragm: Santoprene
 Hardware: Stainless & Zinc Plated Steel

APPROVALS

C-UL, e Mark, C-Tick available

WARRANTY

Aftermarket: 2 Year Limited Warranty
 OEM: Contact OEM
 See MS-030-123 & MS-030-152 for Details

SHIPPING

Net Weight (Boxed): 5 Lb [2.3 Kg] each
 Carton Weight: 12 each, 60 Lb [27 Kg]
 Carton Size: 24"L x 18"W x 11"H [60.9 cm x 45.7 cm x 27.9 cm]

RELATED DOCUMENTS

Catalog: MS-030-083
 Installation Manual: 911-1008
 Maintenance: 911-1008
 Applications Spec Guide: MS-020-005
 Warranty: MS-030-123 [OEM] and MS-030-152 [A/M]

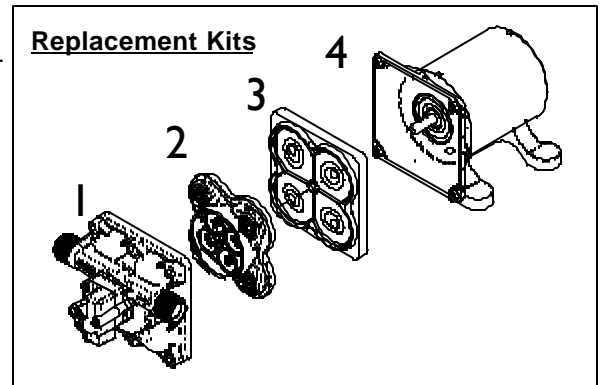

Number	Description	Part Number
1	Upper Assy	94-800-00
2	Valve Assy	94-800-01
3	Drive Assy	94-800-02
4	Motor	11-302-00
Not Shown	Check Valve	94-800-03
1,2,3	Pump Head	94-800-04
Not Shown	Pressure Sw.	94-800-05

PERFORMANCE @ 12V DC

PRESSURE		FLOW		CURRENT
BAR	PSI	GPM	LPM	AMPS
0.0	0	3.0	12.1	2.2
0.7	10	2.2	8.3	3.3
1.4	20	1.8	6.8	4.3
2.1	30	1.5	5.6	5.1
2.8	40	1.2	4.5	6.0
3.4	50	0.5	1.8	6.8

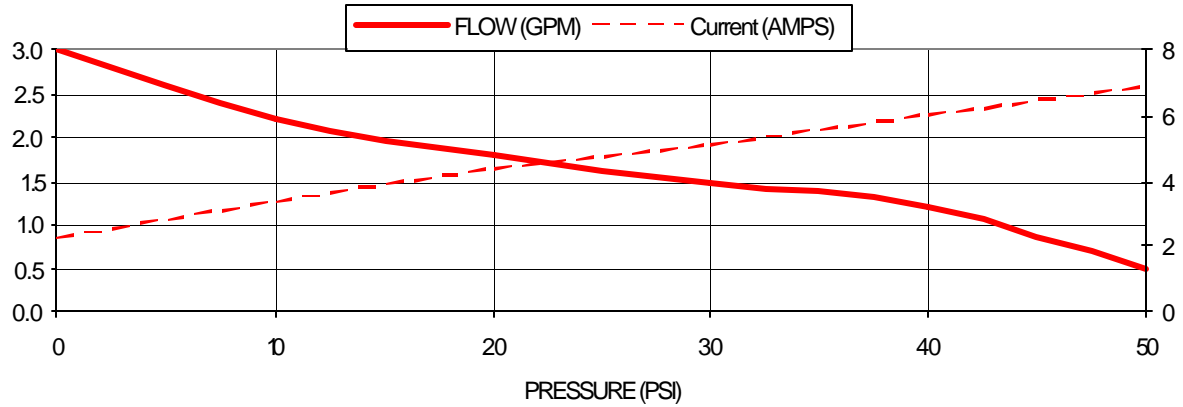

DIMENSIONS [mm]

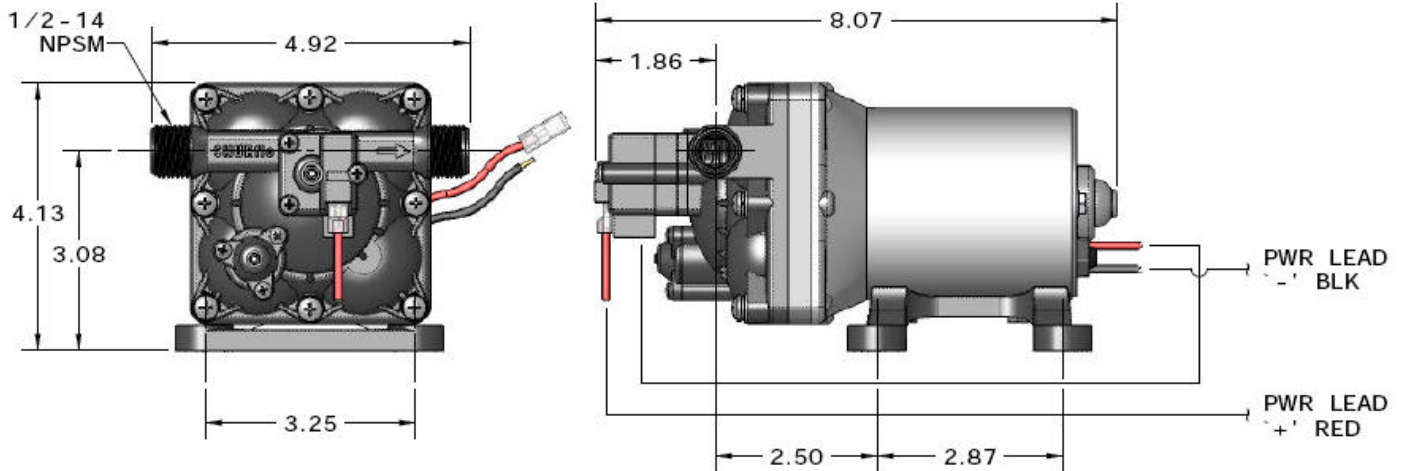

SHURflo reserves the right to update specifications, prices, or make substitutions.



SHURflo, LLC Headquarters

5900 Katella Avenue
Cypress, California 90630
Phone (562) 795-5200 Toll Free (800) 854-3218
Fax (562) 795-7564

SHURflo, LLC East

52748 Park Six Court
Elkhart, Indiana 46514-5427
Phone (562) 795-5200 Toll Free (800) 854-3218
Fax (574) 264-2169

SHURflo Europe, Middle East, Africa

Pentair Water Belgium bvba,
Industriepark Wolfstee, Toekomstlaan 30
B-2200 Herentals, Belgium
Phone +32-14-283500 Fax +32-14-283505