

LCI Electric Stabilizer Foot Pad Adapter Instructions

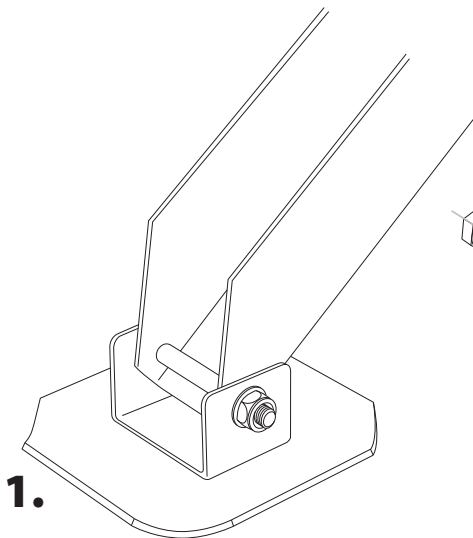

1. Existing foot pad.



2. Remove the bolt that holds the foot pad onto the jack.

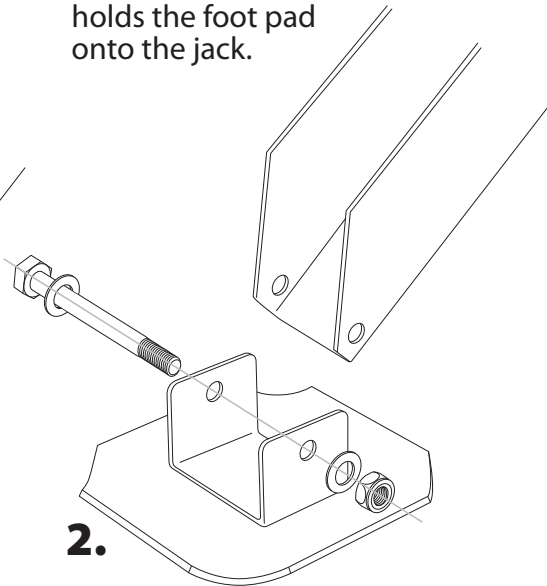

3. Align adapter plates to holes in foot pad. Place the smaller half down and on the outside of brackets.

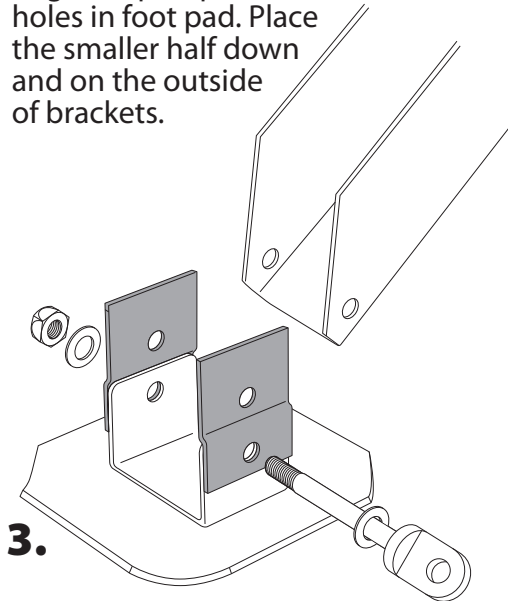

LCI Electric Stabilizer Foot Pad Adapter Instructions



- 4.** Loosely attach 4" swing bolt and adapter plates to foot pad.*

* Adapter plate holes may need to be enlarged using either a 3/8" or 25/64" drill bit.

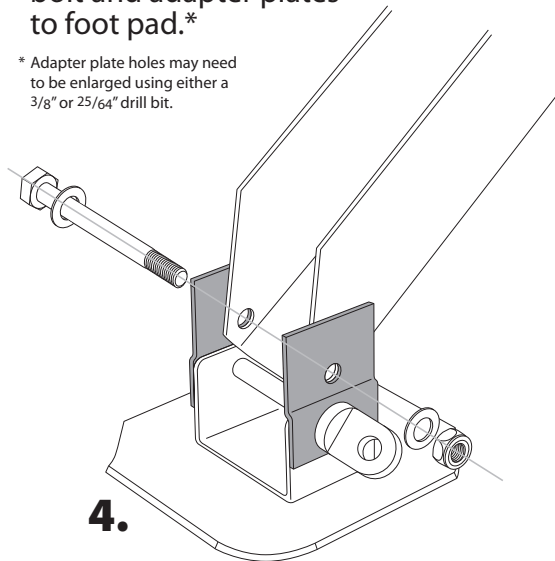

- 5.** Attach the removed bolt to the top hole of the adapter plate through the jack arm. Tighten all bolts.

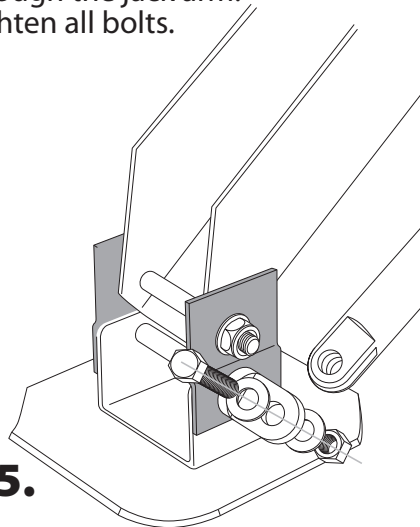

- 6.** Attach JT Strong Arm Stabilizer to the swing bolt and tighten.

