

INSTALLATION INSTRUCTIONS FOR LIF-TABLE BRACKETS

Place the table upside down on a bench with the end even with or slightly extended over the edge. Hang the rod on the table and center.

Place the J003 table brackets over the rod and with the lip of the bracket held up against the table, screw in place. In all instances leave enough space between the edge of the brackets and rod bends to minimize binding. (See figure 1)

With the rod in the same position, turn the table over and place on dinette base cleat up against the wall. (See Figure 2) NOTE: The new J00 or J002 hinge bracket must be held in position firmly on the rod when mounting.

Raise the table to the dining position and place the J001 wall plates over the exposed ends of the J003 table bracket and center. Bring the J001 wall plates down as far as feasible. If possible to the top of the table and fasten the two top holes to the wall. Since the bottom holes are normally below the top of the table, it is necessary to drop the table to the down position to complete this. (See Figure 3)



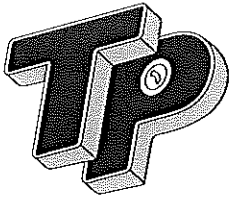

INSTALLATION INSTRUCTIONS FOR LIF-TABLE™ BRACKETS

Install four J005 Base Cleat Brackets on the dinette base so that the dinette table, in the down position, is flush with the seat bench and can accommodate the bench cushions to create a flat bed surface. (Some manufacturers use two small pieces of wood trim installed horizontally to support the table top in the down position).

Place the table upside down on a bench or other working surface with the table end even with or slightly extended over the bench edge. Hang the J025 Bent Rod on the table and center.

Place the J003 Table Brackets over the rod and with the lip of the brackets held up against the table, screw in place (see Figure 1). In all instances leave enough space between the edge of the brackets and rod bends to minimize binding.

Turn the table over and place on dinette base in the down position with the rod in the up position and against the wall (see Figure 2). Mount the J002 or J004 Hinge Brackets in the wall, holding them firmly in position over the rod when mounting (see Figure 3). When using the J004, install the J021 White Clip in the last hole (see Figure 4).

Raise the table to the dining position and place the J001 Wall Mounting Brackets over the exposed ends of the J003 Table Brackets and center. Bring the J001 Wall Mounting Brackets down as far as feasible, if possible, to the top of the table and fasten the two top holes to the wall (see Figure 5.) Since the bottom holes are normally below the top of the table, it is necessary to drop the table to the down position to complete installation of the J001 brackets (see Figure 6).

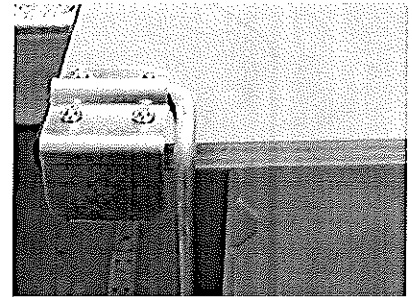

Figure 1

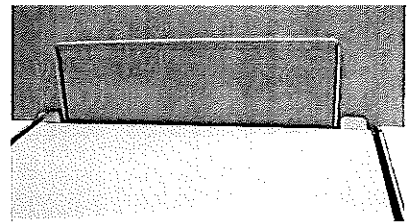

Figure 2

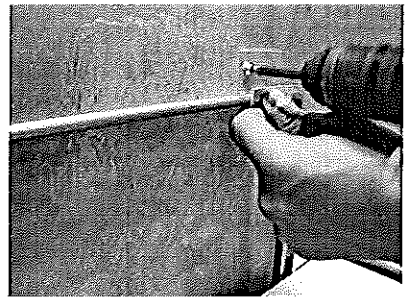

Figure 3

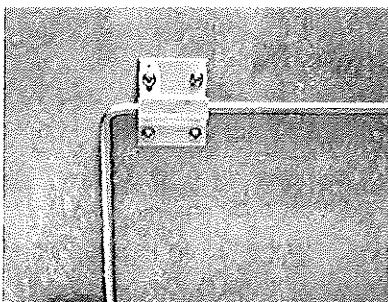

Figure 4

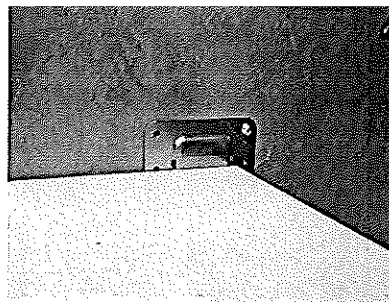

Figure 5

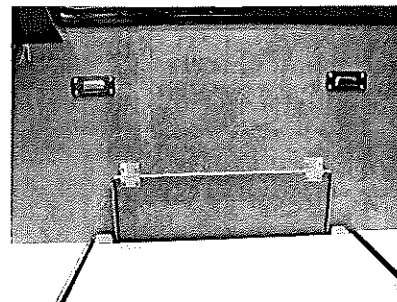

Figure 6